

# Broadband Low Noise RF Amplifier (LNA)



50kHz-20GHz, 28 dB gain

DATASHEET

[Return to the Webpage](#)



This LNA broadband Low Noise RF Amplifier provides output power up to 16 dBm with a gain of 28 dB across a frequency range of 50kHz to 20GHz. It features a noise figure (NF) of 3 dB within the 0.1-20GHz range. The amplifier operates on +12V DC at 160 mA and is equipped with a SMA Female connector.

## Features

- Frequency: 50kHz-20GHz
- Small signal gain: 28dB
- NF=3dB
- Vout=4.48Vpp

## Applications

- 5G Communication
- Test Equipment
- Optical Modulator Driver
- Radar System

## Specifications

| Parameter                   | Min     | Typical     | Max  | Unit |
|-----------------------------|---------|-------------|------|------|
| Frequency Range             | 0.00005 |             | 20   | GHz  |
| Gain                        | 26      | 28          |      | dB   |
| NF (0.1-20GHz)              |         | 3           | 5    | dB   |
| Input Power                 |         | -20         | -10  | dBm  |
| P1dB                        |         | +15         |      | dBm  |
| Psat                        |         | +16         |      | dBm  |
| Drain Supply                | +8V     | +12         | +15  | V    |
| Current                     |         | 160         |      | mA   |
| Input Return Loss           |         | -10         |      | dB   |
| Output Return Loss          |         | -10         |      | dB   |
| Spec Temp                   |         | 25          |      | °C   |
| Drain Supply                |         | +18         |      | V    |
| RF Input Power              |         | +15         |      | dBm  |
| Operating Temperature(note) | -40     |             | +85  | °C   |
| Storage Temperature         | -55     |             | +125 | °C   |
| Input Port                  |         | SMA Female  |      |      |
| Output Port                 |         | SMA Female  |      |      |
| Case Material               |         | Copper      |      |      |
| Finish                      |         | Gold Plated |      |      |
| Weight (Without Heatsink)   |         | 80          |      | g    |
| Size                        |         | See outline |      |      |

**Legal notices:** All product information is believed to be accurate and is subject to change without notice. Information contained herein shall legally bind Agiltron only if it is specifically incorporated into the terms and conditions of a sales agreement. Some specific combinations of options may not be available. The user assumes all risks and liability whatsoever in connection with the use of a product or its application.

Rev 10/24/24

# Broadband Low Noise RF Amplifier (LNA)



50kHz-20GHz, 28 dB gain

## DATASHEET

### Test Data (25°C)

#### Gain vs Frequency 10MHz-20GHz

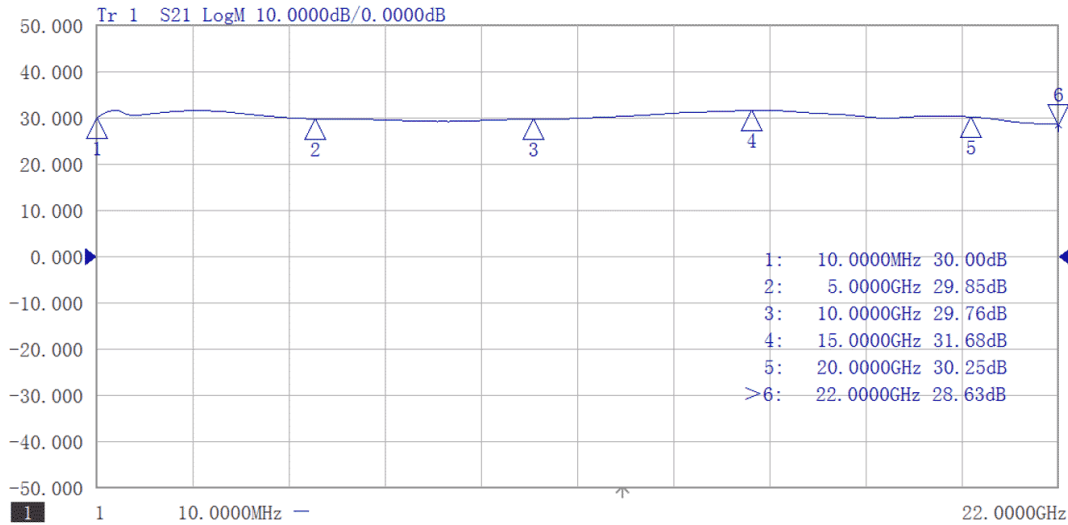

#### Gain vs Frequency 50kHz-1MHz

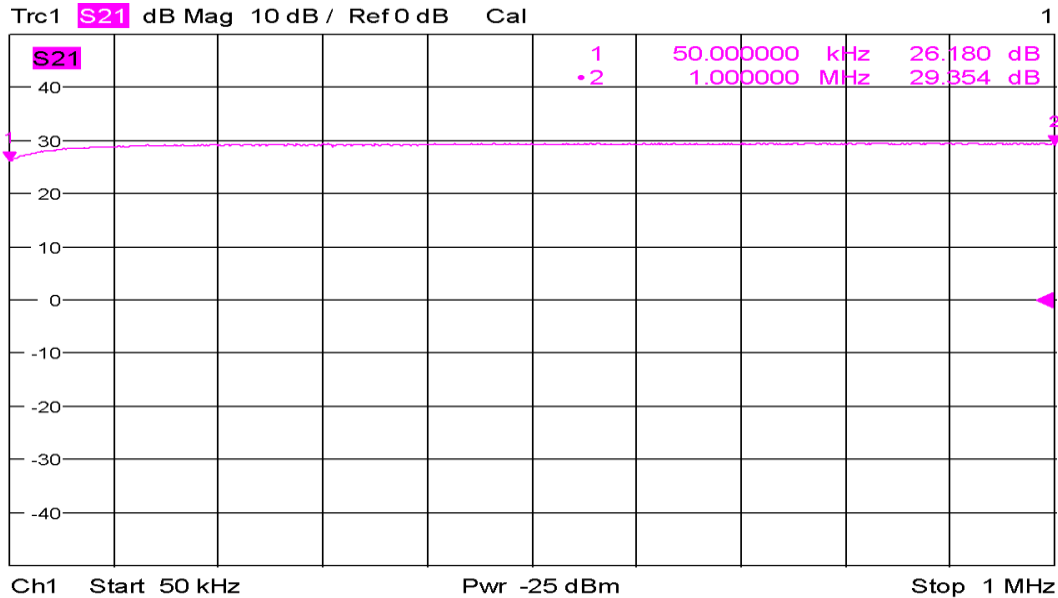

Date: 30.AUG.2021 18:16:21

# Broadband Low Noise RF Amplifier (LNA)



50kHz-20GHz, 28 dB gain

## DATASHEET

### Return Loss vs Frequency 10MHz-20GHz

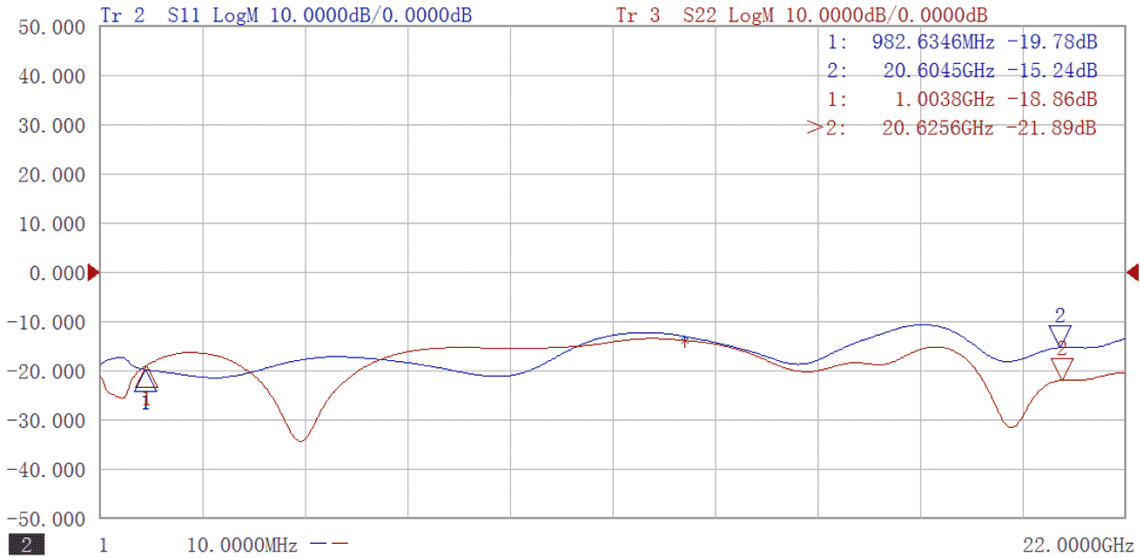

### Return Loss vs Frequency 50kHz-1MHz

Trc1 S11 dB Mag 10 dB / Ref 0 dB Cal Smo 1  
 Trc2 S22 dB Mag 10 dB / Ref 0 dB Cal Smo

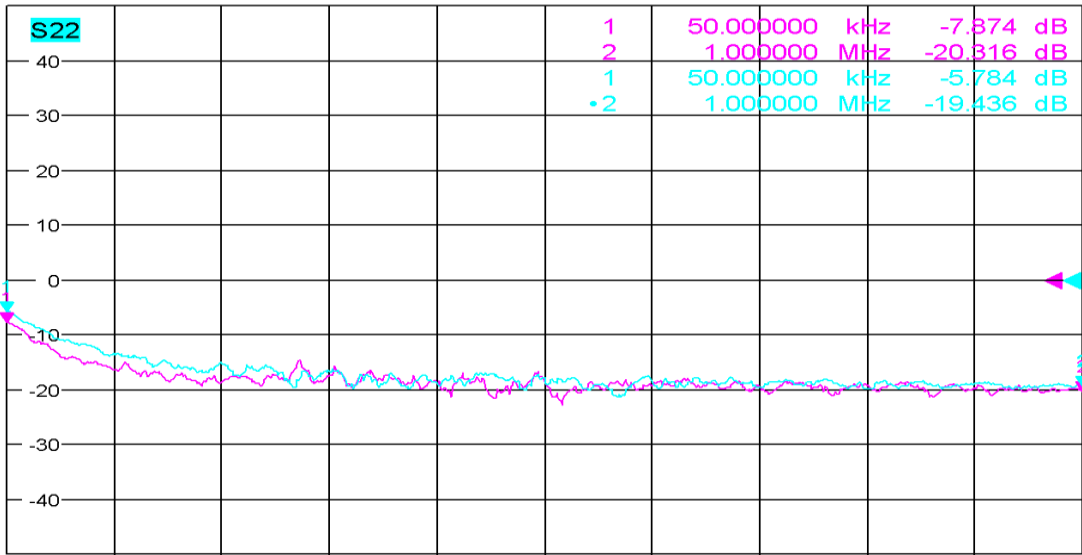

Ch1 Center 525 kHz Pwr -25 dBm Span 950 kHz

Date: 30.AUG.2021 18:32:06

# Broadband Low Noise RF Amplifier (LNA)



50kHz-20GHz, 28 dB gain

## DATASHEET

### P1dB vs Frequency

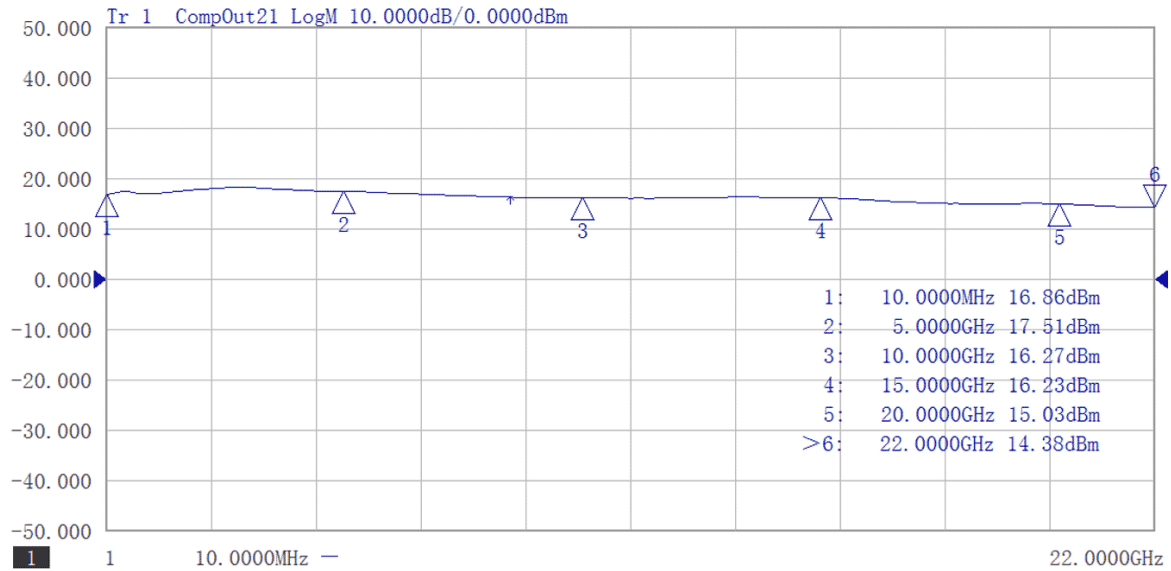

### P3dB vs Frequency

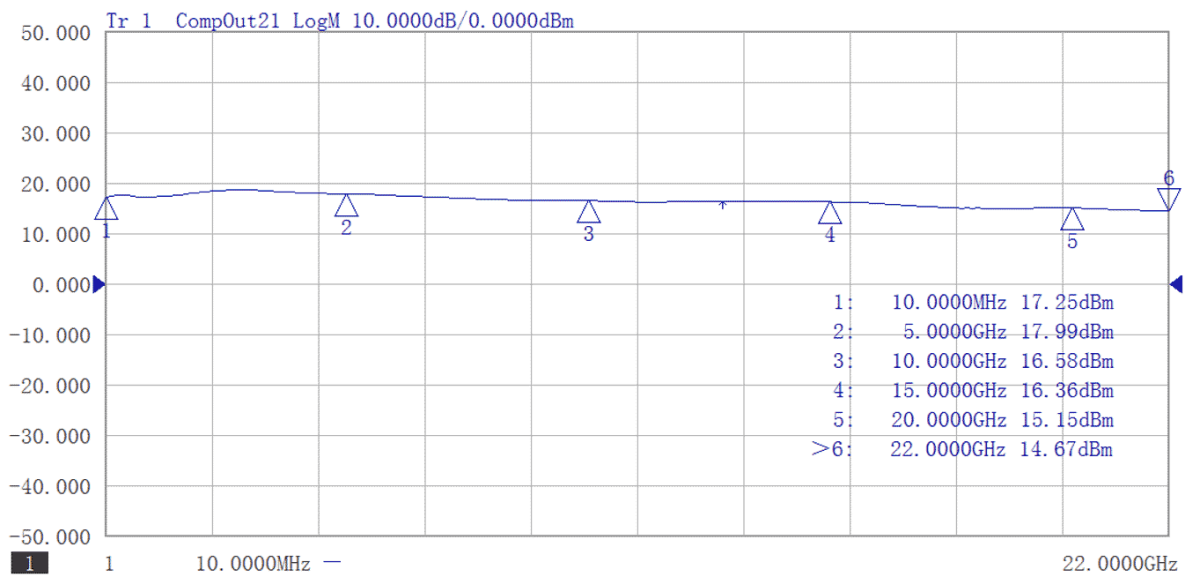

# Broadband Low Noise RF Amplifier (LNA)



50kHz-20GHz, 28 dB gain

## DATASHEET

**Psat vs Frequency at Pin=-5dBm from 10MHz-20GHz**

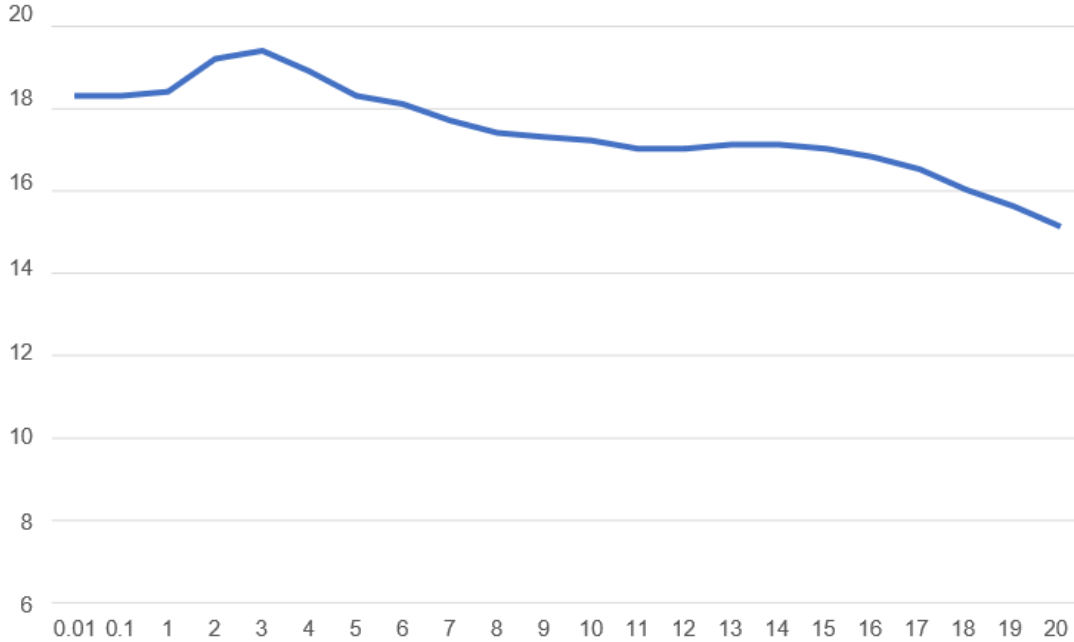

**Phase delay vs Frequency**

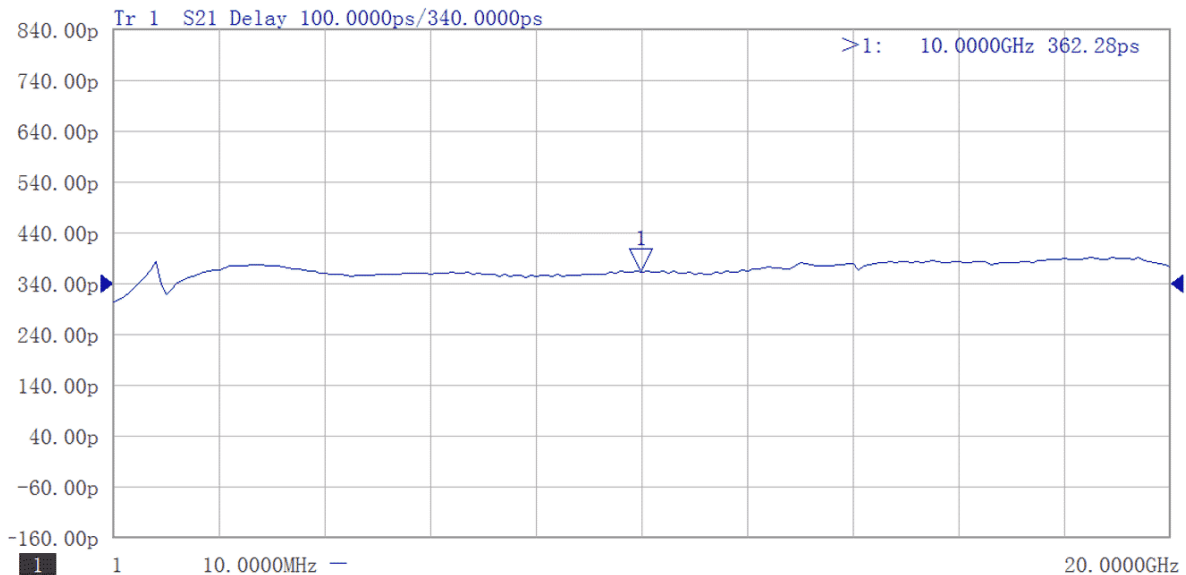

# Broadband Low Noise RF Amplifier (LNA)



50kHz-20GHz, 28 dB gain

## DATASHEET

### NF test vs Frequency 10MHz-1GHz

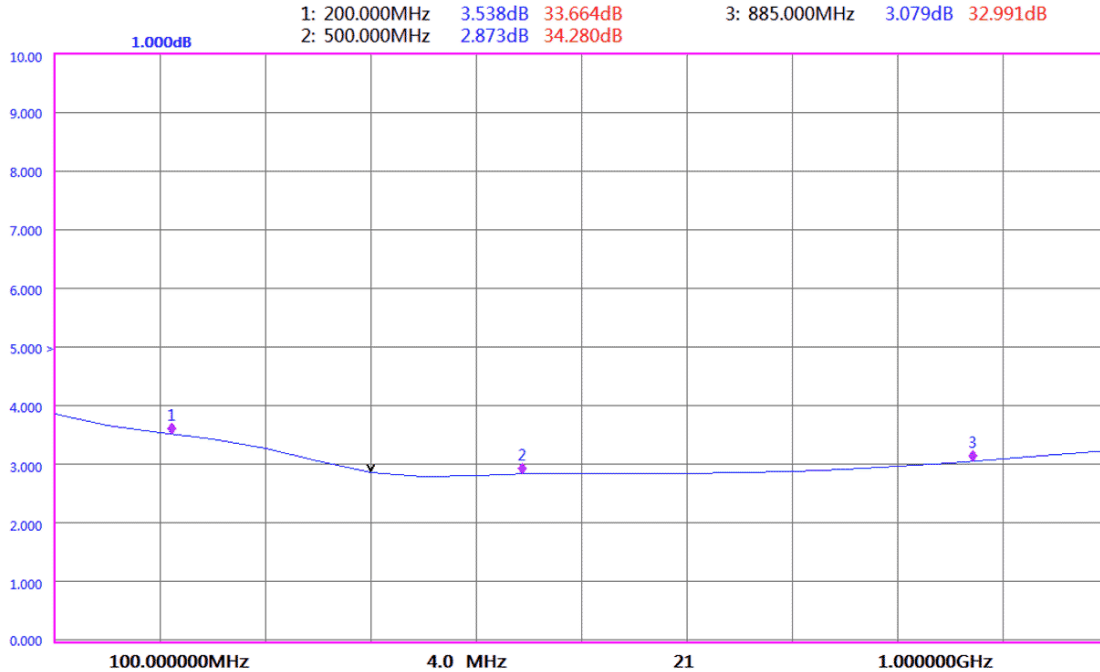

### NF test vs Frequency 1-20GHz

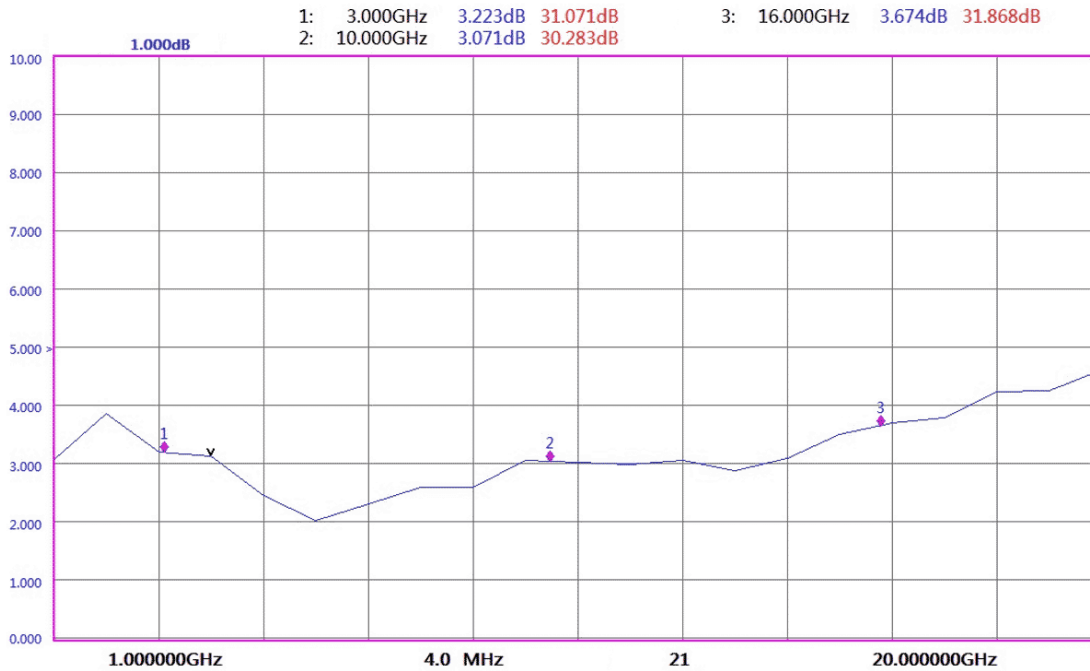

# Broadband Low Noise RF Amplifier (LNA)



50kHz-20GHz, 28 dB gain

## DATASHEET

### Dimensions (mm)

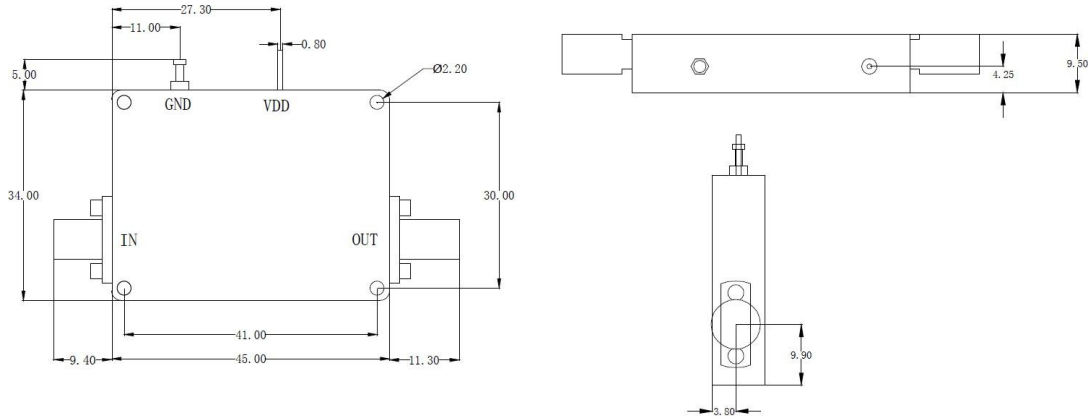

|             | <26.5GHz | <40GHz | <50GHz | <67GHz |
|-------------|----------|--------|--------|--------|
| Connector   | SMA      | 2.92mm | 2.4mm  | 1.85mm |
| Length of a | 9.4mm    | 9.5mm  | 10.8mm | 11.3mm |

Note: Female Default. Contact with us for other types.

Standard module outline, Heat sink required if case temp exceeds 50°C

### -LCBT Option Dimension (mm)

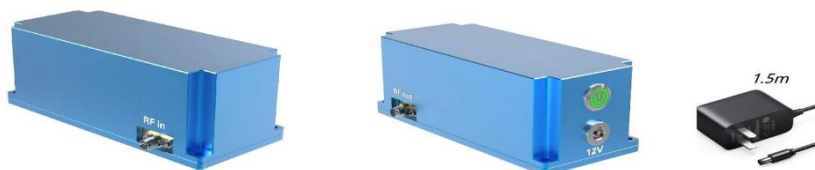
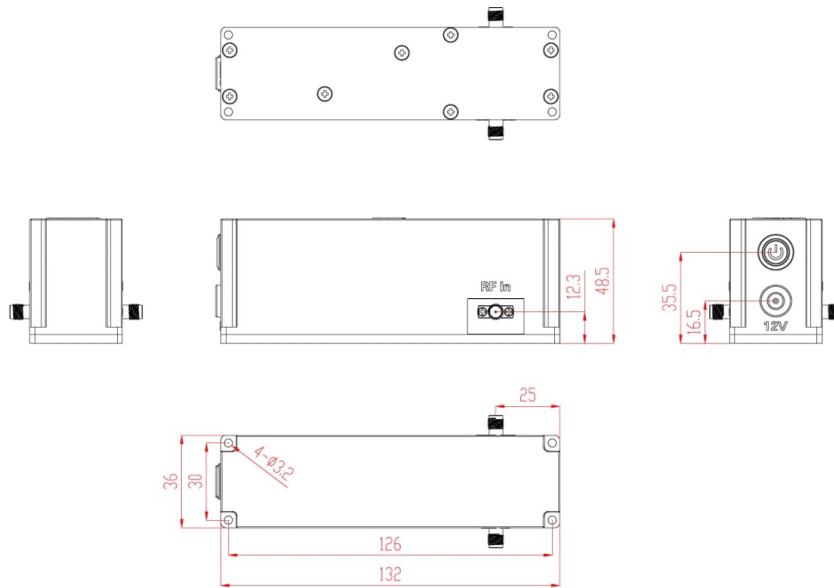

Module \*

# Broadband Low Noise RF Amplifier (LNA)



50kHz-20GHz, 28 dB gain

## DATASHEET

### Ordering Information (Part Number)

| Prefix       | Low Frequency | High Frequency | Gain      | NF      | P1dB       | Module*           |
|--------------|---------------|----------------|-----------|---------|------------|-------------------|
| <b>LNAM-</b> | 50kHz = 0005  | 20GHz = 20     | 28dB = 28 | 3dB = 3 | 15dBm = 15 | No = 0<br>Yes = 1 |